

# ZEBRONICS

Smart LED Projector

# HiFi Pixa Play 58



## User Manual

[www.zebronics.com](http://www.zebronics.com)

## Dear Customer,

Thank you for purchasing the **ZEB-Pixaplay 58 SMART LED Projector**. Please read the user manual carefully before usage & save it for future reference.

### **Note:**

- *To provide a stable power supply, kindly use the cable provided with the product and connect to a AC 230V 50/60Hz power source.*

- *Avoid the self-disassembly of the product as it results in voiding of the product's warranty.*

- *Avoid looking directly at the projector lens while it is active.*

- *Make sure that the projector's air vents are not blocked while in use. The device must be kept in a well ventilated surrounding for proper functioning.*

- *It is recommended to power OFF the projector after a continuous usage of 6 hours maximum.*

- *Place the projector away from water or other liquids. Avoid water accumulation and ensure good ventilation.*

- *In case of enquiry regarding the projector, email us at [enquiry@zebronics.com](mailto:enquiry@zebronics.com) or contact us at 044 4000 0004.*

## Features :

- Home Theater Projectors for Movies, TV & Gaming etc..
- Projector comes with AV IN,AUX OUT,USB x 2,HDMI x 3
- Built in Speaker
- Wide Compatibility
- Remote Control

## Specification :

Screen size	: 127-533cm
Native Resolution	: 1920 x 1080 FHD
Max. Supported Resolution	: 1080p (max)
RAM	: 1 GB
Core Processor	: Quad Core Processor
Storage	: 8 GB
Android Version	: 9.0
WI-Fi Connectivity	: Dual band Connectivity (2.4GHz & 5GHz)
Bluetooth Version	: v5.0
Display Technology	: LCD
Lamp Lifespan	: 50,000h
Brightness	: 11500 Lumens
Contrast ratio	: 1500:1
Projection Distance	: 1.8m - 7.0m
Port Interface	: AV IN,AUX OUT,USB x 2,HDMI x 3

Video file format	: AVI, MPG, MOV, FLV, M2TS, M4V, MTS, MP4, MKV
Input Voltage	: AC 100-240V, 50/60Hz
Product Dimension (W x D x H)	: 25.5 x 19.8 x 10.6 cm
Net. weight	: 1.8kg

### Package Contents :

Projector	: 1 U
Remote Control	: 1 U
Power cord	: 1 U
HDMI Cable	: 1 U
Cleaning cloth	: 1 U
QR Code Guide	: 1 U

### Product Description :

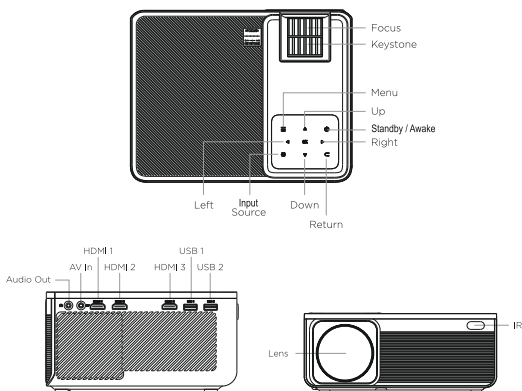

# Remote Control :

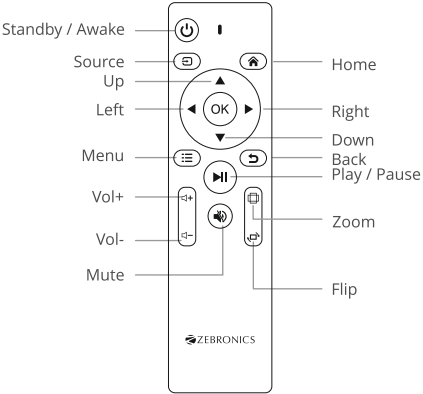

# Setting Up the Projector :

1. Before turning on make sure to place it in a flat surface for proper projection, then press the power button on the projector or on the remote.

2. Align the projector as shown in the image below to ensure proper projection.

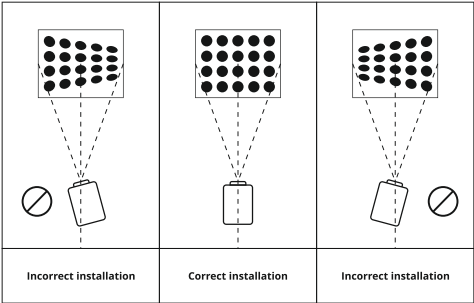

## Projector distance & size :

The recommended projection screen size is 127-533cm. To improve your viewing experience, ensure you have a room where you can control the lighting. These factors work together to provide a visually stunning and immersive viewing experience.

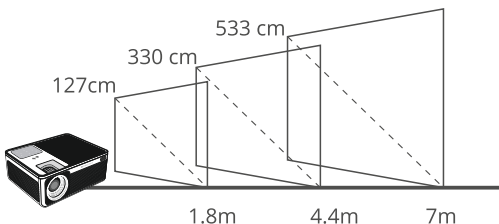

### Note:

*Due to optical device variation of about 3%, the above data is for reference only.*

## BT remote control setup instructions :

Follow the instruction mentioned in the below image to activate and setup BT remote with the projector.

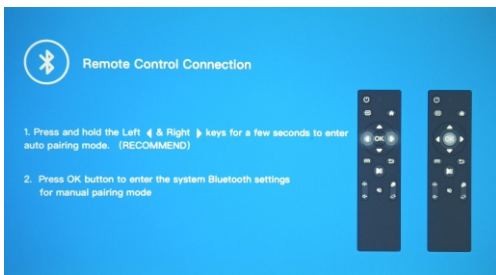

## Input connection instructions :

Follow the steps below for the connection procedure and then press the input source button on the remote/projector and choose the respective input option.

### A. HDMI Connection

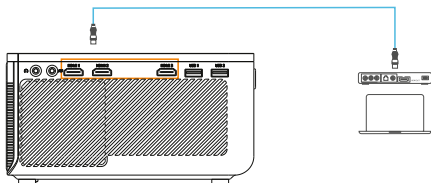

### B. AV Connection

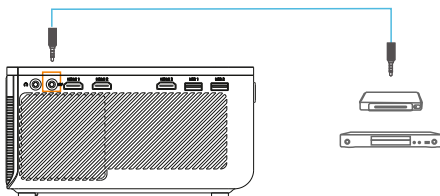

### C. USB Connection

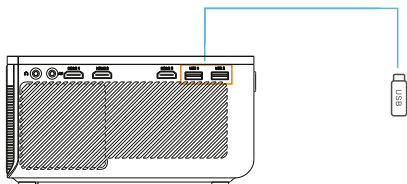

## Android Home :

1. Once the projector is turned on you'll be directed to the home screen.

2.The Home screen displays Fav Apps, App store, Settings Menu, File Manager, Input Source - HDMI,USB,AV, etc.



## Settings:

This settings houses the following submenus : Network settings, Bluetooth settings, projection settings, language setting, system update, other settings.





## Bluetooth Setting :

1. Go to( Settings ) > ( BT Setting)
2. Turn the BT Connection on and search for nearby BT devices.
3. Select your BT device and connect with it.

## Speaker Mode :

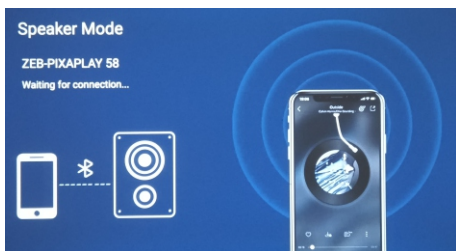

1. Go to settings > Speaker Mode and you can find this device name showing up on your source device. Tap on it and pair with it to use the projector as a BT speaker.

## Screen Mirroring :

Connect your iOS, Android, Laptop or Tablet wirelessly via the device mirroring option. Local photos and videos support screen mirroring.

*Note : Please ensure the projector and your device have been connected to the same Wi-Fi, if there is no Wi-Fi please open a hotspot on your device and connect the projector.*

**ISO 9001:2015 Certified Company**  
**[www.zebronics.com](http://www.zebronics.com)**

